

*Luxury to infinity  
and beyond!*

MORE INFORMATION CALL US



**PROPERTY EXECUTOR**  
LET US BE YOUR PROPERTY GUIDE

**+92 321 2346667**  
RAHEEL ABDUL RAZZAQ

**+92 300 2131616**  
M.SOHAIL

**+92 300 2032023**  
AHMED

Under the Management of:



A Project of:



**Saima**  
WATERFRONT





*Saima*  
WATERFRONT

# A soul-refreshing *Abode.*

Saima Waterfront is a 40-storey residential project of iconic significance coming up right in front of sea in DHA Phase-VIII, Karachi. The project comprises 1, 2, 3 & 4 Bedroom ultra-luxury apartments provided with almost every conceivable amenity of the modern era.

Being away from the clamour and clutter of the city right next to the Arabian Sea, the project boasts of its calm and peaceful environment that's a great fascination for the discriminating class of people.

*Luxury to infinity  
and beyond!*



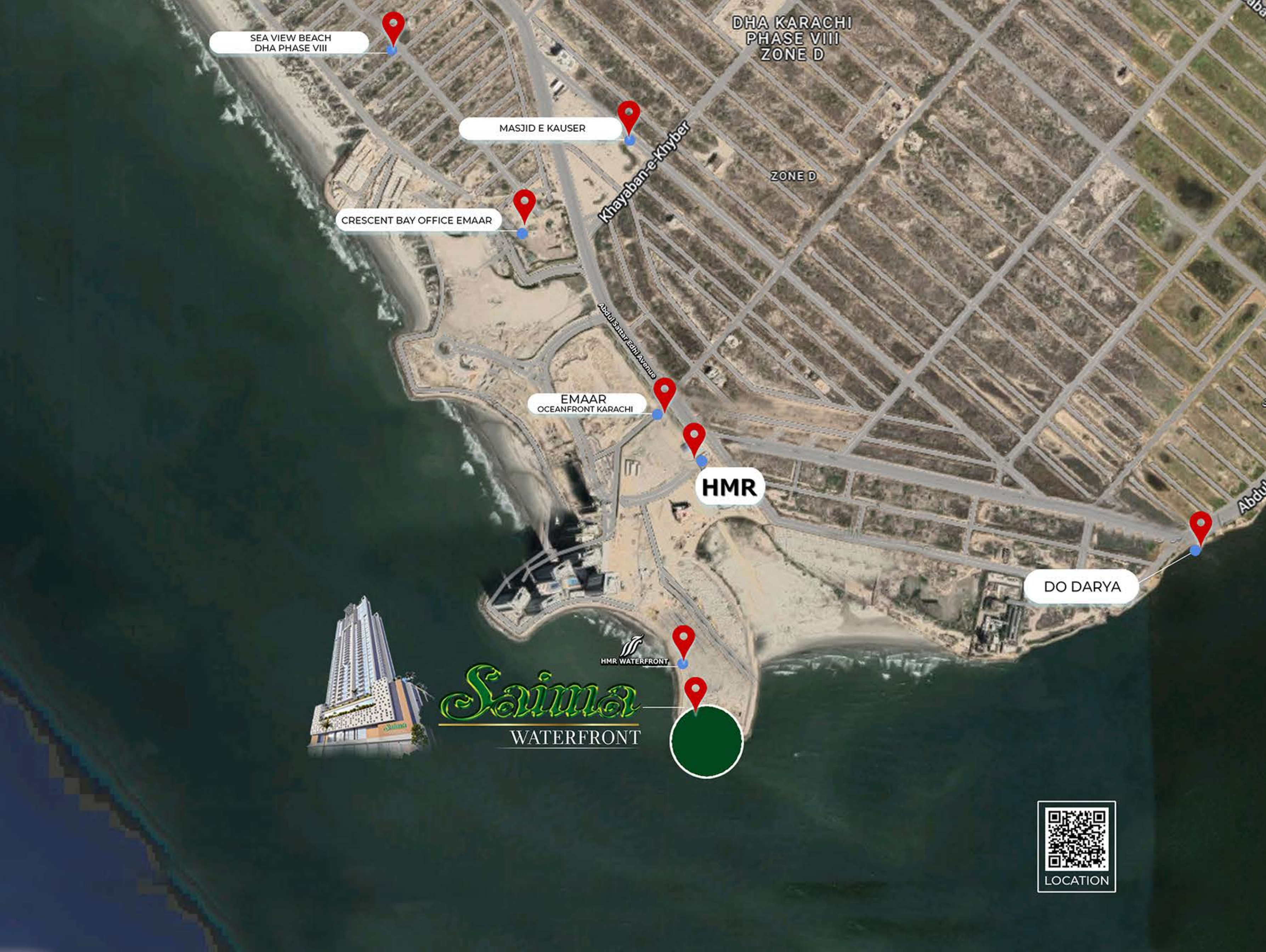

SEA VIEW BEACH  
DHA PHASE VIII

MASJID E KAUSER

CRESCENT BAY OFFICE EMAAR

EMAAR  
OCEANFRONT KARACHI

HMR

DO DARYA



**Saima**  
WATERFRONT

HMR WATERFRONT



LOCATION

# Fascinating *Location.*

Saima Waterfront stands majestically right in front of Arabian Sea enjoying the cool, breezy air and the vast vistas of modern habitations along the coastal area.

Being in a vast open area with a huge waterfront, the project is free from pollution caused by dust and smoke that are peculiar to the congested residential areas of the downtown.



A tall, modern skyscraper with a blue and white facade, illuminated at night. The building has a central vertical section with a glass facade and is surrounded by a landscaped area with trees and a waterfront. A sailboat is visible in the water in the foreground.

*Saima*  
WATERFRONT

# Builders & *Developers.*

The technological advancement in housing & construction industry all over the world is scaling new heights every other day.

By virtue of relentless efforts, construction wizardry and superb craftsmanship gained through decades-long experience, ZSZ Group have taken the gigantic task of constructing Saima Waterfront under their management that enjoys an immaculate track record in the housing & construction industry for well over three decades.

*Luxury to infinity  
and beyond!*



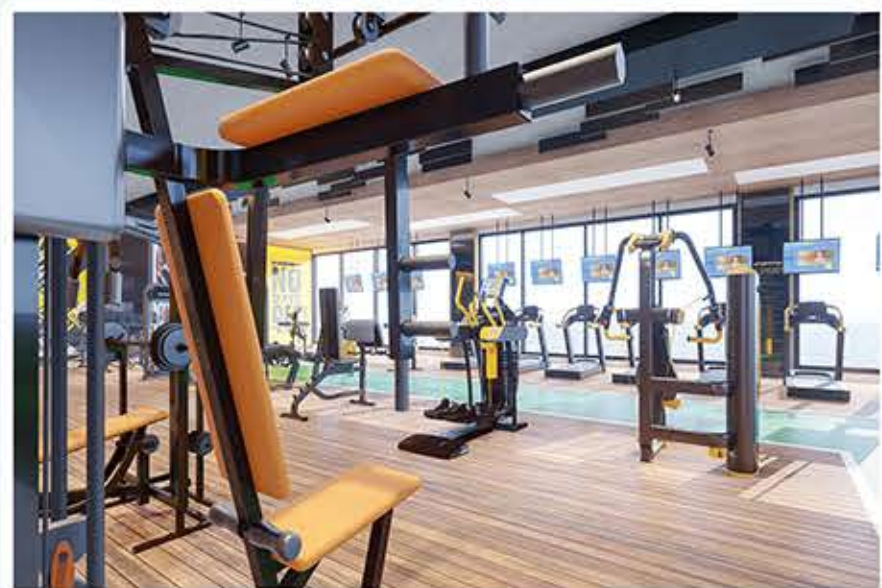

*Saima*  
WATERFRONT

# Distinguishing Features:

-  Earthquake resistant structure
-  Awe-inspiring elevation
-  Elegant reception lobby
-  Hi-speed elevators
-  Cargo lift
-  Six extensive floors allocated for car parking
-  State-of-the-art gym.
-  Swimming pool
-  Play area
-  R.O. plant

*Luxury to infinity  
and beyond!*



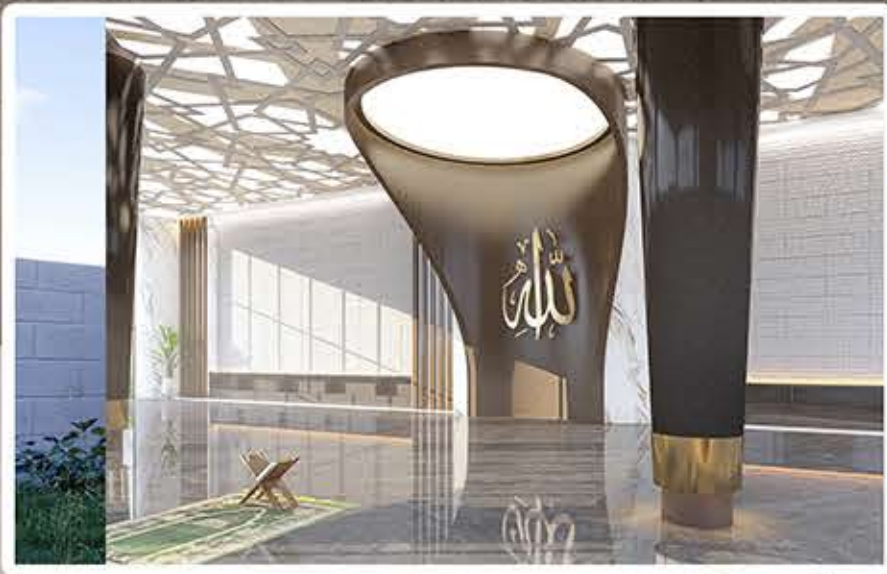





**Saima**  
WATERFRONT



# Distinguishing Features:

-  Sauna & Jacuzzi
-  Standby generators to ensure uninterrupted power supply round-the-clock
-  In-house prayer area
-  Firefighting system
-  CCTV cameras and 24/7 security surveillance

*Luxury to infinity  
and beyond*



# EXTENSIVE LIVING ROOM

*that attracts your guests at a glance*



**Saima**  
WATERFRONT

## Aristocratic Living *Room.*

No amount of facilities can work better unless they match the whims and fancies of every individual dweller. This requires high imagination and extraordinary care on the part of architect and designer.

Providing every conceivable amenity to match your discriminating taste is what aristocratic living is all about.

*Luxury to infinity  
and beyond!*





BEDROOM  
*Ultimate comfort*

## Bedroom

*Ultimate comfort.*

An ideal bedroom is supposed to be the part of a home which spells absolute privacy, perfect peace and ultimate comfort. It's because that greater emphasis is laid on its decor.

*Luxury to infinity  
and beyond!*



KITCHEN

*Cooking excitement*

*Saima*  
WATERFRONT

# | Articulated *Modern Kitchen:*

An artistically designed and lavishly finished kitchen pampers your mood for good cooking. In fact, culinary magic starts where you have everything set to your discerning taste. Therefore, meticulous care has been exercised to make the kitchen environment both exciting and motivating.

*Luxury to infinity  
and beyond!*





# BATHROOM

*Relaxing sensation*

**Saima**  
WATERFRONT

## *Trendy* Bathroom:

Bathroom enjoys an exclusive place in home comforts for its immediate concern with health and hygiene. An ideal bathroom gives you a soothing bath besides keeping you fit and healthy.

*Luxury to infinity  
and beyond!*





A Dream Home  
is a great  
blessing for you  
and your

*Dear Ones...*

At long last, you are blessed with an awesome dream home for which you must be striving since long. It's really a moment of great pleasure and happiness for you and your dear ones and expected to bring peace and comfort beyond match.

**Saima**  
WATERFRONT

*Luxury to infinity  
and beyond!*



Artfully  
*Designed*  
Reception Lobby

*Saima*  
WATERFRONT

*Saima*  
WATERFRONT

*Luxury to infinity  
and beyond!*



*Now* NO MORE WAITING  
FOR YOUR *Dream Lifestyle*

## The Living *Fantasy.*

Living in coastal area right in front of sea has always been a burning desire of affluent community all over the world.

The glamour of turquoise blue waters and the glittering waves rippling over and over especially under the moonlight add a lot to your optical pleasure while cool, breezy air makes you crazy for hours and hours together with your loved ones.

*Luxury to infinity  
and beyond!*



MAKE EVERYDAY A  
*Memorable one*

*Saima*  
WATERFRONT

Make everyday a  
*Memorable one.*

From morning till evening or even at midnight, you will be having stunning views that will fill you with a joy that you have never ever experienced.

So, have a nice day everyday with your loved ones and enjoy life to its full.



*Saima*  
WATERFRONT

Just a walk away  
from

*Promenade  
Board Walk.*



Lush green  
avenues and tracts



Clubhouse



Located at the seafront,  
offering enchanting  
views round-the-clock

*Luxury to infinity  
and beyond!*





*Saima*  
WATERFRONT

# Team Behind *The Project.*



**ZEESHAN SALEEM ZAKI**  
GROUP



**ARCH VISION**  
ARCHITECTS, ENGINEERS & TOWN PLANNERS  
105, Alif Trade Centre, 5th-20 Block 15-C Main University Road,  
Doha - P.O. Box 10000, Doha - Qatar  
Email: info@archvision.qa, Website: www.archvision.qa



**mushtaq and bilal**  
CONSULTING ENGINEERS



**ZEESHAN ALI**  
ARCHITECTS

**ElekEn Associates**  
MEP Consultants



**SEM Engineers**  
Structural, Electrical, Mechanical,  
Environmental & Management



**HMR WATERFRONT**

*Luxury to infinity  
and beyond!*